



4 5 3 5 8 4 0 0 2 * (1)

Television

Operating Instructions

BRAVIA

Customer support
<http://www.sony-asia.com/support>
<http://www.sony.net>
 © 2014 Sony Corporation Printed in China

KLV-24P422B/24P412B / 22P402B

Overview of the remote

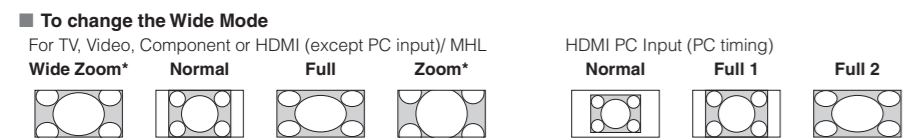
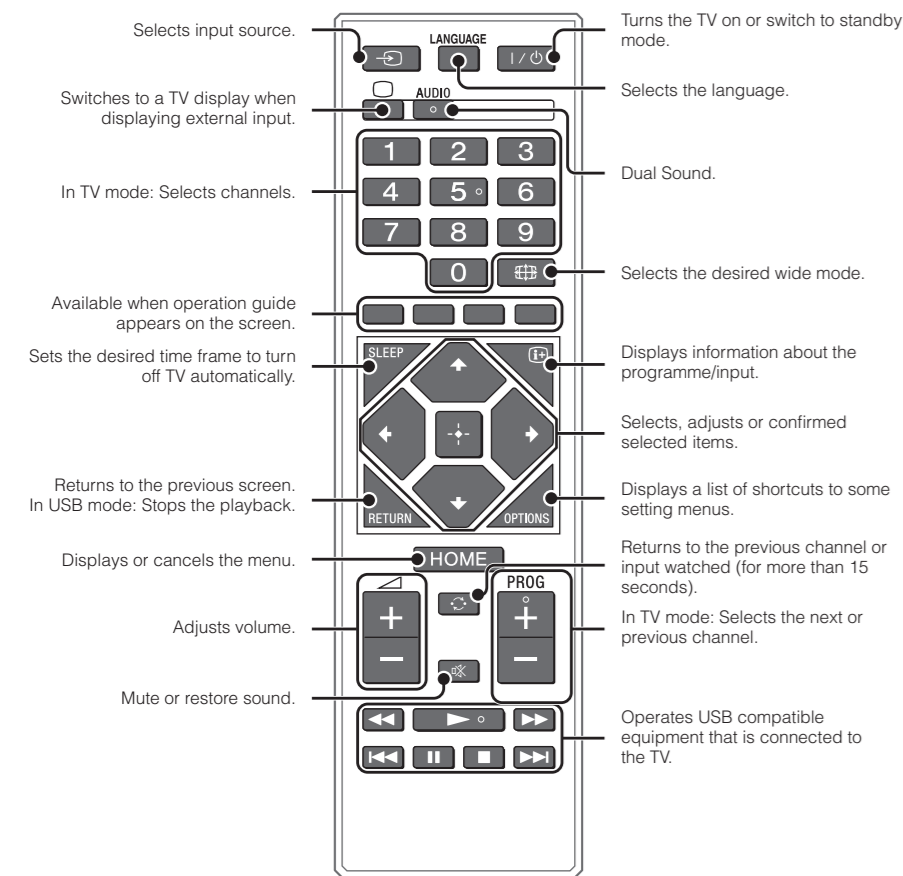

* Parts of the top and bottom of the picture may be cut off.
 † Some options may not be available depending on the signal source.

Checking the accessories

- Table-Top Stand (1)*
- Fixing screws for Table-Top Stand (M4 x 16) (3)
- Remote control (1)
- AC power cord (mains lead) (1)
- Size AAA batteries (R03 type) (2)
- Operating instructions (this manual) and other documents

* Refer to the supplied Table-Top Stand leaflet to assemble the Table-Top Stand.

1: Attaching the Table-Top Stand

- If using an electric screwdriver, set the tightening torque at approximately 1.2 N·m (12 kgf·cm).

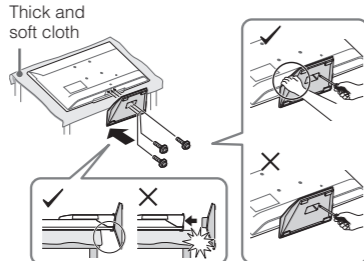

Detaching the Table-Top Stand from the TV

- Do not remove the Table-Top Stand for any reason other than to wall-mount the TV.

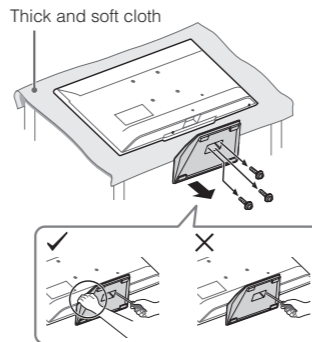

2: Mounting the TV on the wall

To Customers
 Sufficient expertise is required for installing this product. Be sure to subcontract the installation to Sony dealers or licensed contractors and pay special attention to safety during the installation. Sony is not liable for any damages or injury caused by mishandling or improper installation, or installing any other than the specified product. Your Statutory Rights (if any) are not affected.

To Sony Dealers and Contractors
 Sufficient expertise is required for installing this product. Be sure to read this instruction manual thoroughly to do the installation work safely. Sony is not liable for any damages or injury caused by mishandling or improper installation.

Precautions

- Detach the Table-Top Stand from the TV. For details, refer to (Detaching the Table-Top Stand from the TV).

Wall mount location

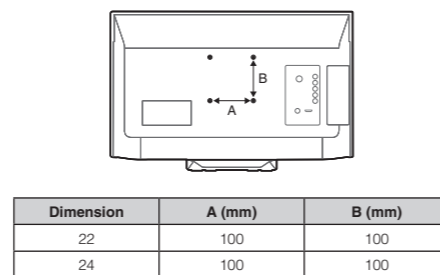

Dimension	A (mm)	B (mm)
22	100	100
24	100	100

3: Connections

Connecting an antenna (aerial)/cable

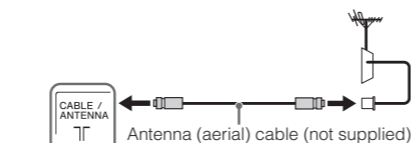

Connecting an antenna (aerial)/cable and VCR

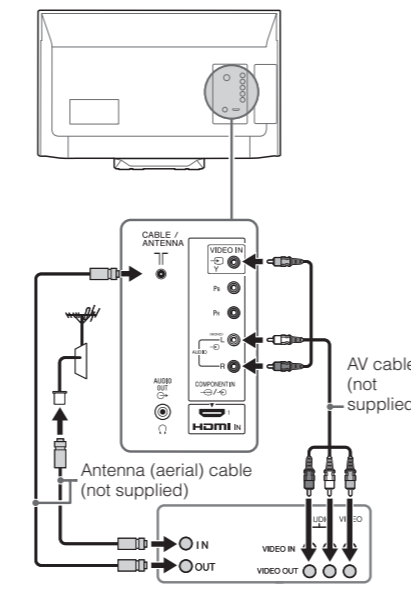

Connecting audio/video devices

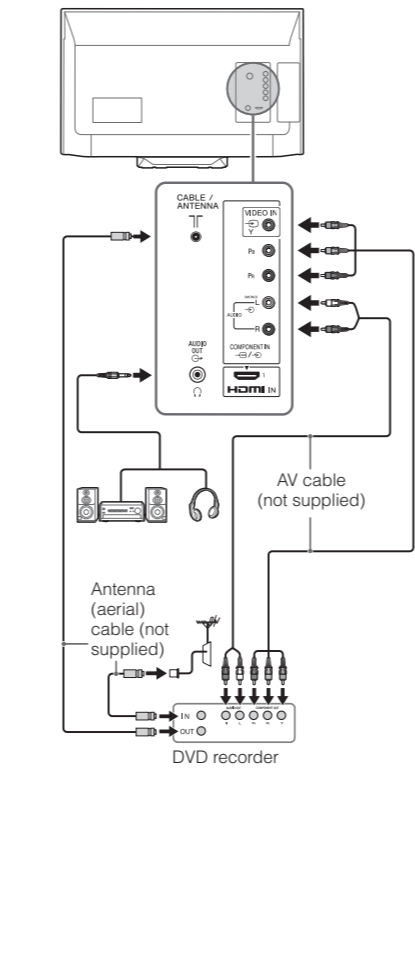

Connecting MHL device (KLV-24P422B only)

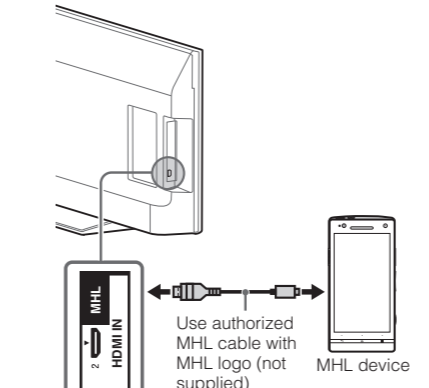

The MHL (Mobile High-Definition Link) enables the TV to communicate with a connected MHL-compatible device. The TV can charge the connected MHL-compatible device while playing photo/music/video from it. You can use the TV remote control to control the connected MHL-compatible device.

- If "Auto Input Change (MHL)" is set to "On", the TV automatically switches to HDMI 2 / MHL from other input when MHL-compatible device is connected to HDMI IN 2 / MHL jack. The availability of "Auto Input Change (MHL)" depends on whether the MHL-compatible device can support this feature.
- You can continue normal usage of the connected MHL-compatible device (such as receiving calls) depending on its capability.
- Some remote control functions may not be available depending on features of the connected MHL-compatible device. Please refer to the device manual for details.
- This product is officially MHL-certified for operation with other MHL-certified devices. If you encounter any problems when using the MHL function, please consult the device manufacturer for support.

4: Preventing the TV from toppling over

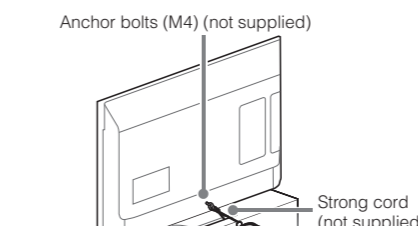

5: Performing the initial setup

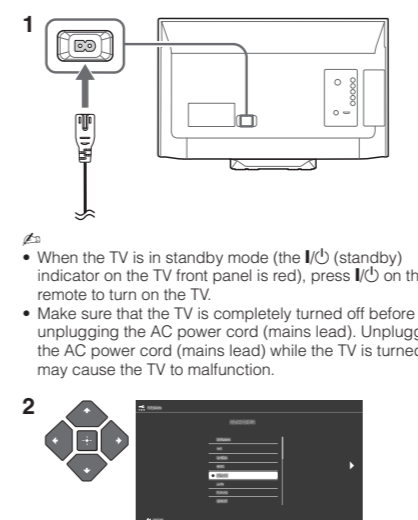

- Follow the instructions on the screen.
- You can also tune channels manually.
- Language options vary depending on model.
- Select "Home" from "Location" for the best TV settings to use the TV in the home.

Overview of the TV controls and indicators

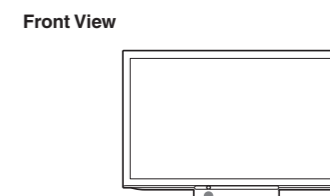

- Power/Standby indicator**
 - Lights up in red when in standby.
 - Lights up in green when the TV is turned on.
 - Flashes while the remote is being operated.

- Do not put anything over the sensor, doing so may affect its function.

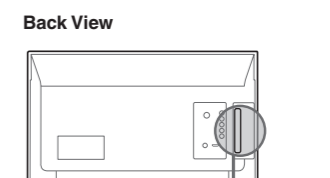

- Power**
Turns the TV on or switch to standby mode.
- CHINPUT**
 - Press button until "Input select" appears and selects channels with Volume button.
 - Press button until "Input select" appears and selects input source with Volume button.
- Volume**
 - Adjusts volume.
 - Moves through options up or down when selecting channels or input source.

Viewing pictures from the connected equipment

Turn on the connected equipment, then press **[CHINPUT]** on the remote control or CHINPUT on the TV to display the connected equipment list.

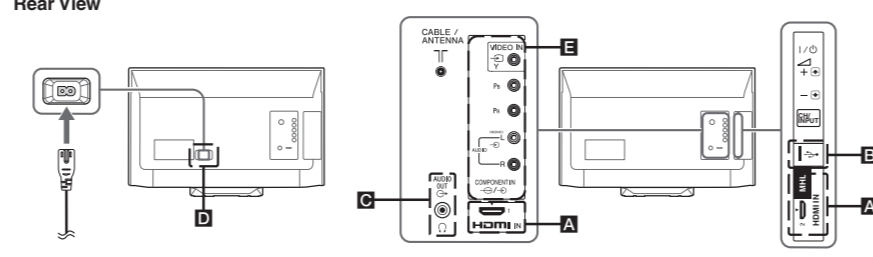

- HDMI IN 1, HDMI IN 2 / MHL and HDMI IN 2 (Home Theatre systems, Camcorder, Blu-ray Disc player, DVD player, PC with HDMI output and Mobile device).**
 Connect to the HDMI IN jack if the equipment has an HDMI jack. If the equipment is compatible with MHL, connect the MHL jack of the equipment to the HDMI IN 2 / MHL jack through a MHL - HDMI cable (not supplied).
- The HDMI jacks can support PC timing in HDMI PC mode. Refer to (PC input signal reference chart for HDMI IN 1, 2) next to "PC settings".
- Be sure to use only an authorized HDMI cable bearing the HDMI logo, or an authorized MHL cable bearing the MHL logo.
- [Digital still camera, Camcorder, USB storage media]**
 Access photo/music/video files stored on a USB device.
- AUDIO OUT (Stereo systems, Headphones)**
 Connect with an audio cable or headphones. You can listen to TV sound through your stereo system or headphones. You can select "Variable" or "Fixed" in the "Audio Out" menu.
- AC IN 110 V - 240 V AC, 50/60 Hz**

- VIDEO IN (COMPONENT IN/AUDIO (DVD player, VCR, Video game equipment, S VHS/Hi8/DVC camcorder, DVD player with component output)**
 Connect to the VIDEO IN jack and the AUDIO jack. If you connect mono equipment, connect to the L (MONO) jack. For better picture quality, component connection is recommended if your DVD player has a component video output. Connect to the COMPONENT IN jacks.

Using Menu Functions

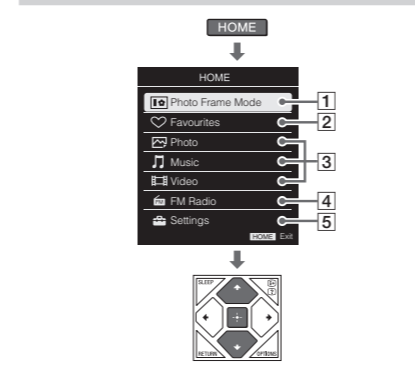

1 Photo Frame Mode (KLV-24P422B only)

Display Photo, Music and Clock calendar at the same time.

- To enter Photo Frame Mode: **[HOME]** → "Photo Frame Mode"
- To select Photo/Music: In Photo Frame Mode, **[MUSIC]** → "Image Selection" / "Music Selection"
- To select Display Mode: In Photo Frame Mode, **[DISPLAY]** → "Display Mode"

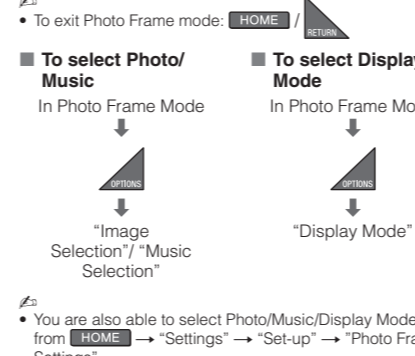

- You are also able to select Photo/Music/Display Mode from **[HOME]** → "Settings" → "Set-up" → "Photo Frame Settings".

2 Favourites

Store up to 18 channels or external inputs.

- To add a current channel or external inputs into Favourites list: **[HOME]** → "Favourites" OR **[ADD]** → "Add to Favourites"
- To watch a channel or external input: **[HOME]** → "Favourites" → [Channel]

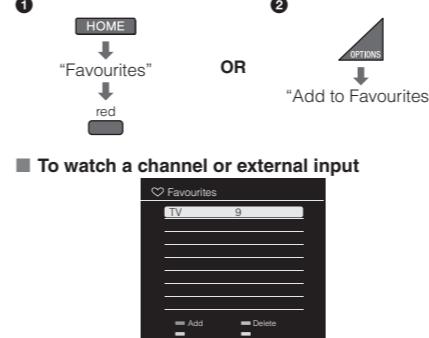

3 Photo/Music/Video

Playback photo/music/video files via USB devices.

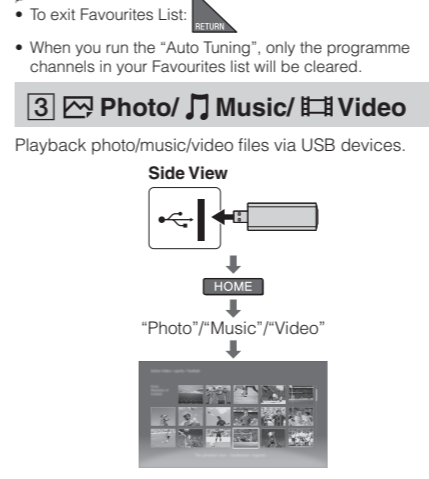

- If more than one USB detected: **[REDACTED]** → "Device Selection"
- If you connect the USB device when "USB Auto Start" is set to "On", the thumbnail view of photo/music/video appears automatically.

To adjust the picture and sound setting (Video)

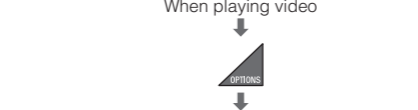

To play a photo as slideshow (Photo)

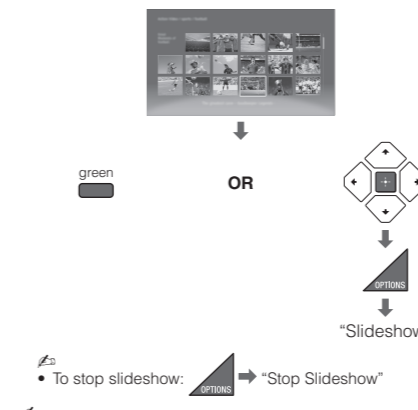

- To stop slideshow: **[STOP]** → "Stop Slideshow"
- While the TV is accessing the data on the USB device, do not turn off the TV or connected USB device, disconnect the USB cable, or remove the USB device.
- When you run the "Auto Tuning", only the programme channels in your Favourites list will be cleared.
- The file name and folder name may not display correctly in some cases.
- When you connect a Sony digital still camera, set the camera's USB connection mode to Auto or Mass Storage. For more information about USB connection mode, refer to the instructions supplied with your digital camera.
- Check the website below for updated information about compatible USB devices.
<http://www.sony-asia.com/bravia/flash.html>
- Use a USB storage device that is compliant with USB mass storage device class standards.

USB Video format

Extension	Container	Video Codec	Audio Codec
.avi	AVI	MPEG1 MPEG2 xvid MPEG4 H.264 MPEG	PCM AC3 MPEG1 Layer1/2 MPEG2 AAC MPEG4 AAC MPEG4 HE-AAC WMA V8 MP3
.wmv .asf	ASF	WMV9 xvid MPEG4 VC-1	MP3 WMA V8
.mp4 .mov .3gp	MP4	MPEG4 H.264 H.263 MPEG	MPEG1 Layer1/2 MP3 MPEG2 AAC MPEG4 AAC MPEG HE-AAC
.mkv	MKV	WMV9 MPEG4 H.264 VC-1	PCM MP3 MPEG1 Layer1/2 MPEG2 AAC MPEG4 AAC MPEG4 HE-AAC WMA V8 AC3
.mpg .mpeg .vob	MPEG1	MPEG1	MPEG1 Layer1/2 MP3 AC3
.ts .m2ts	MPEG2TS	MPEG2 H.264 VC-1	MPEG1 Layer1/2 MP3 AC3 MPEG2 AAC MPEG4 HE-AAC MPEG4 AAC

USB Music format

Extension	Audio Codec
.mp3	MPEG1 Audio Layer 3
.wma	WMA V8
.wav	LPCM

USB Photo format

Extension	Image Codec
.jpg .jpe .png	JPEG

- DCF2.0 or EXIF2.21 supported.
- Playback of the above file formats is not guaranteed.
- The USB device supports FAT16, FAT32 and NTFS.

FM Radio

- For first time using FM Radio function:



- To access FM Radio mode:



- To listen to preset stations:

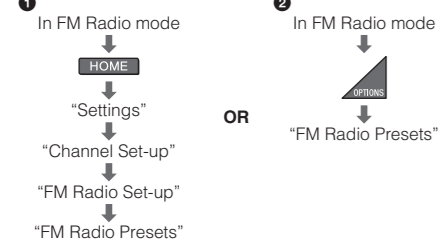

- To exit "Channel Set-up" menu:
- To select desired preset FM Radio stations:



- To listen to non-preset stations:



- If "Please set-up FM Radio" appears, perform **Listen to preset stations**.



- To exit setting mode:
- The options you can adjust vary depending on the situation. Unavailable options are greyed out or not displayed.

To show photo or picture while listening to FM Radio

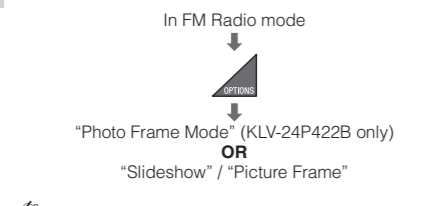

- To exit "Photo Frame Mode"/"Slideshow"/"Picture Frame":



- To reduce power consumption in FM Radio:

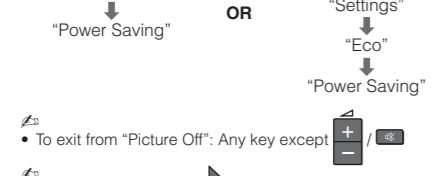

- To exit from "Picture Off": Any key except
- To exit FM Radio mode:
- If the station has a noisy sound, press to improve the sound quality.

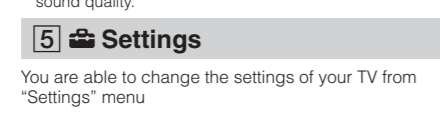

- To select setting options:

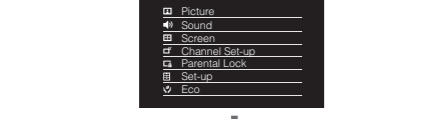

- You are able to change the settings of your TV from "Settings" menu.

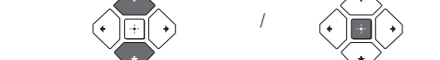

- To select "Settings" category:
- To modify the setting:

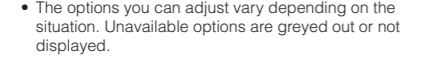

- To exit the setting mode:
- The options you can adjust vary depending on the situation. Unavailable options are greyed out or not displayed.



- To exit the setting mode:
- The options you can adjust vary depending on the situation. Unavailable options are greyed out or not displayed.

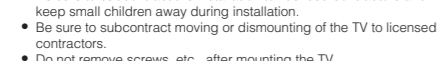

Environment

- Places that are hot, humid, or excessively dusty, where insects may enter, where it might be exposed to mechanical vibration, near flammable objects (candles, etc.). The TV set shall not be exposed to dripping or splashing and no objects filled with liquids, such as vases, shall be placed on the TV.
- Do not place the TV in a humid or dusty space, or in a room with oily smoke or steam (near cooking tables or humidifiers). Fire, electric shock, or warping may result.
- Do not install the TV in places subject to extreme temperature such as in direct sunlight, near a radiator or a heating vent. The TV may overheat in such condition which can cause deformation of the enclosure or TV malfunction.



- Do not use when your hands are wet, with the cabinet removed, or with attachments not recommended by the manufacturer. Disconnect the TV set from AC power outlet (mains socket) and antenna during lightning storms.
- Do not install the TV so that it sticks out into an open space. Injury or damage from a person or object bumping into the TV may result.

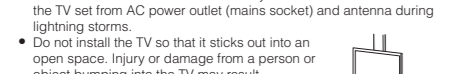

- Do not throw anything at the TV set. The screen glass may break by the impact and cause serious injury.
- If the surface of the TV set cracks, do not touch it until you have unplugged the AC power cord (mains lead). Otherwise electric shock may result.

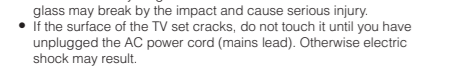

- If you will be using the TV set for several days, the TV set should be disconnected from the AC power (mains) for environmental and safety reasons.
- As the TV set is not disconnected from the AC power (mains) when the TV set is just turned off, pull the plug from the AC power outlet (mains socket) to disconnect the TV set completely.
- However, some TV sets may have features that require the TV set to be left in standby to work correctly.

- Do not allow children to climb on the TV set.
- Keep small accessories out of the reach of children, so that they are not mistakenly swallowed.

- If the following problems occur...

- Turn off the TV set and unplug the AC power cord (mains lead) immediately if any of the following problems occur. Ask your dealer or Sony service centre to have it checked by qualified service personnel.

- When:
 - AC power cord (mains lead) is damaged.
 - Poor fitting of AC power outlet (mains socket).
 - TV set is damaged by being dropped, hit or having something thrown at it.
 - Any liquid or solid object falls through openings in the cabinet.

- About LCD Monitor Temperature

When the LCD Monitor is used for an extended period, the panel surrounds become warm. You may feel hot when touching there by the hand.

- WALL-MOUNT BRACKET

Below information shows the correct handling of the Wall-Mount Bracket. Be sure to read this information thoroughly and use the Wall-Mount Bracket correctly.

Picture

- Picture Mode Sets a picture mode.

- Reset Resets all the "Picture" settings to factory settings, except "Picture Mode" and "Intelligent Picture Plus Set-up".

- Backlight Adjusts the brightness of the backlight.

- Picture Increases or decreases picture contrast.

- Brightness Brightens or darkens the picture.

- Colour Increases or decreases colour intensity.

- Hue Increases or decreases the green tones and red tones.

- Sharpness Sharpens or softens the picture.

- Colour Temperature Adjusts the whiteness of the picture.

- Noise Reduces the picture noise (noisy picture) in a weak broadcast signal.

- MPEG Noise Reduction Reduces the picture noise in MPEG-compressed video.

- Cinema Drive Provides improved picture movement when playing BD (Blu-ray Disc™), DVD or VCR images taken on film, reducing picture blur and graininess.

- If the image contains irregular signals or too much noise, "Cinema Drive" is automatically turned off even if "Auto" is selected.

- Advanced Settings Set "Picture" settings in more detail.

- Intelligent Settings Enhances picture quality according to preferred settings, channel or video input.

- Picture Plus Set-up Assigns a channel name of your choice up to seven letters or numbers.

- Manual Programme Preset Sets programme channels manually.

- Sound Sets a sound mode.

- Sound Mode Resets all the "Sound" settings to factory settings, except "Sound Mode", "Dual Sound", "Speakers" and "Audio Out".

- Treble Adjust the treble level.

- Bass Adjust the bass level.

- Simulated Stereo Adds a surround-like effect to mono programmes.

- Intelligent Volume Minimizes the difference in volume level between all programmes and adverts.

- Balance Emphasizes left or right speaker balance.

- Volume Offset Adjusts the volume level of the current input relative to other inputs.

- Dual Sound Sets the sound from speaker for a stereo or bilingual broadcast.

- Vertical Shift Adjusts the vertical position of the picture when "Wide Mode" is set to "Wide Zoom" or "Zoom".

- PC Settings Selects screen mode or adjusts the display position of the picture when the TV receives an input signal from the connected HDMI PC.

- Auto Display Area Selects "On" to automatically adjust the display area based upon the content or "Off" to choose from the "Display Area" options.

- Horizontal Shift Adjusts the horizontal position of the picture when "Wide Mode" is set to "Wide Zoom" or "Zoom".

- Vertical Shift Adjusts the vertical position of the picture when "Wide Mode" is set to "Wide Zoom" or "Zoom".

- PC Settings Selects screen mode or adjusts the display position of the picture when the TV receives an input signal from the connected HDMI PC.

- Auto Display Area Selects "On" to automatically adjust the display area based upon the content or "Off" to choose from the "Display Area" options.

- Horizontal Shift Adjusts the horizontal position of the picture when "Wide Mode" is set to "Wide Zoom" or "Zoom".

- Vertical Shift Adjusts the vertical position of the picture when "Wide Mode" is set to "Wide Zoom" or "Zoom".

- PC Settings Selects screen mode or adjusts the display position of the picture when the TV receives an input signal from the connected HDMI PC.

- Auto Display Area Selects "On" to automatically adjust the display area based upon the content or "Off" to choose from the "Display Area" options.

- Horizontal Shift Adjusts the horizontal position of the picture when "Wide Mode" is set to "Wide Zoom" or "Zoom".

- Vertical Shift Adjusts the vertical position of the picture when "Wide Mode" is set to "Wide Zoom" or "Zoom".

- PC Settings Selects screen mode or adjusts the display position of the picture when the TV receives an input signal from the connected HDMI PC.

- Auto Display Area Selects "On" to automatically adjust the display area based upon the content or "Off" to choose from the "Display Area" options.

- Horizontal Shift Adjusts the horizontal position of the picture when "Wide Mode" is set to "Wide Zoom" or "Zoom".

- Vertical Shift Adjusts the vertical position of the picture when "Wide Mode" is set to "Wide Zoom" or "Zoom".

- PC Settings Selects screen mode or adjusts the display position of the picture when the TV receives an input signal from the connected HDMI PC.

- Auto Display Area Selects "On" to automatically adjust the display area based upon the content or "Off" to choose from the "Display Area" options.

- Horizontal Shift Adjusts the horizontal position of the picture when "Wide Mode" is set to "Wide Zoom" or "Zoom".

- Vertical Shift Adjusts the vertical position of the picture when "Wide Mode" is set to "Wide Zoom" or "Zoom".

PC input signal reference chart for HDMI IN 1, 2

Signals	Horizontal (mm)	Vertical (mm)	Horizontal Frequency (kHz)	Vertical Frequency (Hz)	Standard
VGA	640	480	31.5	60	VGA
SVGA	800	600	37.9	60	VESA Guidelines
XGA	1024	768	48.4	60	VESA Guidelines
WXGA	1280	768	47.4	60	VESA
WXGA	1280	768	47.8	60	VESA
WXGA	1360	768	47.7	60	VESA
SXGA*	1280	1024	34	60	VESA
HDTV*	1920	1080	67.5	60	EIA

- * KLV-22P402B only

- This TV's PC input does not support Sync on Green/Composite Sync and interfaced signal.
- This TV's PC supports signals in the above chart with a 60 Hz vertical frequency.

- When "1 Digit Direct" is set to "On", select a channel using one preset number button (0 - 9) on the remote.

- When "1 Digit Direct" is set to "On", you cannot select channel numbers 10 and above entering next digit using the remote.

- Auto Tuning Tunes in all the available channels.

- Programme Sorting Changes the order in which the channels are stored on the TV.

- Programme Labels Assigns a channel name of your choice up to seven letters or numbers.

- Manual Programme Preset Sets programme channels manually.

- In "Audio Filter", you cannot receive stereo or dual sound when "High" is selected.

- FM Radio Set-up Preset up to 30 FM radio stations that can be received in your area.

- Parental Lock Sets up TV to block channel or external input. Use 0-9 on the remote to enter a four-digit PIN code.

- Change PIN Code Selects a individual channel your PIN code.

- Programme Block Blocks an individual channel from being watched. To view a blocked channel, select "Unblocked".

- External Input Locks an external input from being watched. To view a blocked external input, select "Unblocked".

- Auto Display Area Selects "On" to automatically adjust the display area based upon the content or "Off" to choose from the "Display Area" options.

- Horizontal Shift Adjusts the horizontal position of the picture when "Wide Mode" is set to "Wide Zoom" or "Zoom".

- Vertical Shift Adjusts the vertical position of the picture when "Wide Mode" is set to "Wide Zoom" or "Zoom".

- PC Settings Selects screen mode or adjusts the display position of the picture when the TV receives an input signal from the connected HDMI PC.

- Auto Display Area Selects "On" to automatically adjust the display area based upon the content or "Off" to choose from the "Display Area" options.

- Horizontal Shift Adjusts the horizontal position of the picture when "Wide Mode" is set to "Wide Zoom" or "Zoom".

- Vertical Shift Adjusts the vertical position of the picture when "Wide Mode" is set to "Wide Zoom" or "Zoom".

- PC Settings Selects screen mode or adjusts the display position of the picture when the TV receives an input signal from the connected HDMI PC.

- Auto Display Area Selects "On" to automatically adjust the display area based upon the content or "Off" to choose from the "Display Area" options.

- Horizontal Shift Adjusts the horizontal position of the picture when "Wide Mode" is set to "Wide Zoom" or "Zoom".

- Vertical Shift Adjusts the vertical position of the picture when "Wide Mode" is set to "Wide Zoom" or "Zoom".

- PC Settings Selects screen mode or adjusts the display position of the picture when the TV receives an input signal from the connected HDMI PC.

- Auto Display Area Selects "On" to automatically adjust the display area based upon the content or "Off" to choose from the "Display Area" options.

- Horizontal Shift Adjusts the horizontal position of the picture when "Wide Mode" is set to "Wide Zoom" or "Zoom".

- Vertical Shift Adjusts the vertical position of the picture when "Wide Mode" is set to "Wide Zoom" or "Zoom".

- PC Settings Selects screen mode or adjusts the display position of the picture when the TV receives an input signal from the connected HDMI PC.

- Auto Display Area Selects "On" to automatically adjust the display area based upon the content or "Off" to choose from the "Display Area" options.

- Horizontal Shift Adjusts the horizontal position of the picture when "Wide Mode" is set to "Wide Zoom" or "Zoom".

- Vertical Shift Adjusts the vertical position of the picture when "Wide Mode" is set to "Wide Zoom" or "Zoom".

- PC Settings Selects screen mode or adjusts the display position of the picture when the TV receives an input signal from the connected HDMI PC.

- Auto Display Area Selects "On" to automatically adjust the display area based upon the content or "Off" to choose from the "Display Area" options.

- Horizontal Shift Adjusts the horizontal position of the picture when "Wide Mode" is set to "Wide Zoom" or "Zoom".

- Vertical Shift Adjusts the vertical position of the picture when "Wide Mode" is set to "Wide Zoom" or "Zoom".

- PC Settings Selects screen mode or adjusts the display position of the picture when the TV receives an input signal from the connected HDMI PC.

- Auto Display Area Selects "On" to automatically adjust the display area based upon the content or "Off" to choose from the "Display Area" options.

- Horizontal Shift Adjusts the horizontal position of the picture when "Wide Mode" is set to "Wide Zoom" or "Zoom".

- Vertical Shift Adjusts the vertical position of the picture when "Wide Mode" is set to "Wide Zoom" or "Zoom".

Specifications

System

- Panel system LCD (Liquid Crystal Display) Panel

- TV system B/G, I, D/K, M

- Colour/video system PAL, PAL60, SECAM, NTSC4.43, NTSC3.58

- Channel Coverage Analogue: UHF/VHF/Cable, depending on your country/area selection.

- Sound Output 5 W + 5 W

- Input/Output jacks Antenna (aerial)/Cable 75 ohm external terminal for VHF/UHF

- COMPONENT IN/OUT AUDIO Y/Pb/P (Component Video): 1080p (50, 60Hz), 1080i (50, 60Hz), 720p (50, 60Hz), 576p, 576i, 480p, 480i Audio input (phono jacks)

- VIDEO IN Video input (common phono pin with Y input)

- HDMI IN 1, 2 (HDMI IN 2 for KLV-24P412B & KLV-24P422B only) Video: 1080p (24, 30, 50, 60Hz), 1080i (50, 60Hz), 720p (24, 30, 50, 60Hz), 576p, 576i, 480p, 480i PC Formats Audio: Two channel linear PCM: 32, 44.1 and 48kHz, 16, 20 and 24 bits, Dolby Digital

- without Table-Top Stand KLV-24P422B: 558 x 367 x 147 mm KLV-24P412B: 558 x 341 x 65 mm KLV-22P402B: 509 x 340 x 147 mm

- Mass (Approx.) with Table-Top Stand KLV-24P422B: 4.2 kg KLV-24P412B: 4.2 kg KLV-22P402B: 3.8 kg

- without Table-Top Stand KLV-24P422B: 4.0 kg KLV-24P412B: 4.0 kg KLV-22P402B: 3.6 kg

- AUDIO OUT(*) Audio output (stereo minijack) Headphones jack

- USB port

- Power consumption KLV-24P422B: 43 W KLV-24P412B: 37 W KLV-22P402B: 29 W

- Dimensions (Approx.) (w x h x d) with Table-Top Stand KLV-24P422B: 558 x 367 x 147 mm KLV-24P412B: 558 x 341 x 65 mm KLV-22P402B: 509 x 340 x 147 mm

- without Table-Top Stand KLV-24P422B: 558 x 341 x 65 mm KLV-24P412B: 558 x 341 x 65 mm KLV-22P402B: 509 x 314 x 65 mm

- Mass (Approx.) with Table-Top Stand KLV-24P422B: 4.2 kg KLV-24P412B: 4.2 kg KLV-22P402B: 3.8 kg

- without Table-Top Stand KLV-24P422B: 4.0 kg KLV-24P412B: 4.0 kg KLV-22P402B: 3.6 kg

- Design and specifications are subject to change without notice.

- Others Operating temperature 0°C - 40°C

- Operating humidity 10% - 80% RH (non-condensing)

- Power and others Power requirements AC IN 110 V ~ 240 V AC, 50/60 Hz

- Screen size (measured diagonally) (Approx.) KLV-24P422B: 59.8 cm / 24 inches KLV-24P412B: 59.8 cm / 24 inches KLV-22P402B: 54.7 cm / 22 inches

- Display resolution KLV-24P422B: 1,366 dots (horizontal) × 768 lines (vertical) KLV-24P412B: 1,366 dots (horizontal) × 768 lines (vertical) KLV-22P402B: 1,920 dots (horizontal) × 1,080 lines (vertical)

- Power consumption KLV-24P422B: 43 W KLV-24P412B: 37 W KLV-22P402B: 29 W

- Dimensions (Approx.) (w x h x d) with Table-Top Stand KLV-24P422B: 558 x 367 x 147 mm KLV-24P412B: 558 x 341 x 65 mm KLV-22P402B: 509 x 340 x 147 mm